



DIY CABINET REFACING INSTALLATION GUIDE

CABINET REFACING INSTALLATION

Are you ready to reface your outdated cabinets? This guide will show you how to install your new Facelifters Cabinet Refacing Products to transform your kitchen or bathroom cabinets.



www.facelifters.com



More saving. More doing.®

About Facelifters Cabinet Doors

Facelifters is a leading manufacturer and distributor of cabinet doors, drawer fronts and related accessories. We offer an entire line of doors and drawer fronts in select grade woods as well as Rigid Thermofoil (RTF) to suit the taste of different customers. The doors and accessories come in classic and contemporary designs, various color stain and paint finishes, with multiple options for panels. The accessories available range from a cross section of popular moldings, valances to hardware (knobs and handles), breadboards, and cutlery trays.

This manual provides basic installation instructions for the refacing items available through The Home Depot, for the 'Do-It-Yourself' customer. If you prefer to have this installed for you, we offer installation services.

Please contact **1-800-HOMEDEPOT** for details.



Installing Facelifters Refacing Materials

STEP 1 – Receive Your Order

- Use the Measure Guide to measure and order your material
- Check all parts against your original order before you begin refacing

STEP 2 – Prepare Cabinets

- Remove all contents of cabinets
- Remove existing door fronts and drawer fronts/boxes
- Sand and clean all surfaces for good adhesion of materials

STEP 3 – Install Materials

- Install toe kicks, bottom flushing materials (if desired) and end panels
- Sand cabinet faces, clean and allow to dry thoroughly
- Install vertical stiles
- Install horizontal rails
- Trim excess material

STEP 4 – Install Doors, Drawers and Hardware

- Install drawer boxes and glide hardware (if ordered)
- Install door hinges and doors
- Install drawer fronts
- Install hardware and accessories



How To Install

Tools Needed:

- Tape measure
- 150 grit sandpaper and sanding block
- Razor knife
- Scissors
- Tack cloth
- Hammer
- Wood block with damp rag (to use as applicator)
- 4" straight edge or putty knife
- 3' straight edge
- Adhesive spray or roll on glue
- Carpenter's glue
- Drill
- Screwdrivers: flathead and phillips
- Miter box & saw
- Finishing nails for molding (and pre-finished plywood, if installing Wood refacing)

Before beginning installation check all items for correct size, quantity and color.

Step 1: Prepare Surfaces

- Remove your old doors by removing the screws from the hinges.
- Remove old drawer boxes (set aside if reusing).
- Remove all moldings around and above cabinets.
- Remove any loose or peeling coatings from any surface you will be refacing.
- Fill in any voids in the surface with wood putty (follow instructions on wood putty container).
- Sand all surfaces with 150 grit sandpaper. You do not need to remove all existing finishes; you just need to roughen the surface for a good bond.
- Clean all surfaces with a clean cloth with mineral sprits. Allow to dry thoroughly.
- Wipe surfaces with a tack cloth to remove any remaining dust or sanding particles.

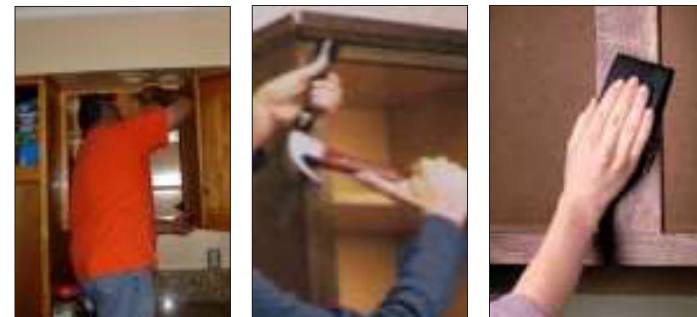

Step 2: Cover End Panels

Cut-to-size End Panels:

- Start by applying the cut-to-size plywood to the cabinet end panels. Apply wood glue to the back of the plywood, then fit it to end panel, making sure it is flush with the cabinet front and bottom.
- Use finishing nails to secure.
- Using sanding block with 150 grit sandpaper, sand the edges of the plywood to ensure that it is flush with cabinet front frame. Use a clean tack cloth to remove the sanding dust.

- Fill in any voids where the end panel meets the face with wood filler. Sand with sanding block, and clean with tack cloth.

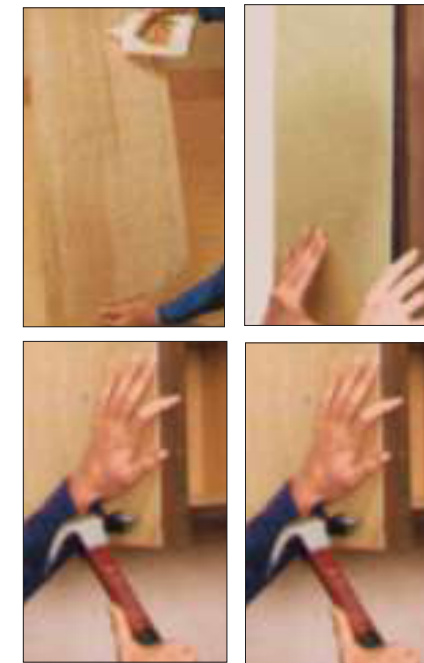

Step 3: Facing

CUT SELF-ADHESIVE COVERINGS:

- Cut self-adhesive covering into strips 1/2" wider, and about 2" longer for each stile and rail you will be covering.

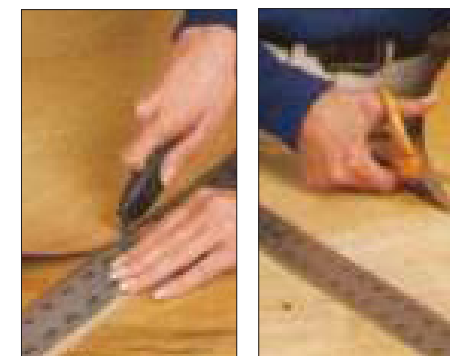

APPLY COVERINGS ONE OPENING AT A TIME:

- Start with the stiles. Peel back just enough backing from the top of the strip. Place so that top edge of strip is flush and square with the top of the stile. Align so there is an even overlap on each side of the stile. Press and smooth downward, peeling the backing paper as you go.

- Repeat this process on the other stiles.
- Now do the rails. Peel back just enough backing paper from one end of the strip. Align so that it overlaps the left and right stiles by approx. 1", and the top and bottom of the rail evenly.
- Press and smooth across, peeling the backing paper as you go. Repeat on other rails.



- Trim the overlap inside the opening with a razor knife.
- Trim the overlap from the top and bottom of the cabinet.



- Align a straight edge flush with the inside of the stile. Cut through the overlaps on both the stile and rail. Remove the excess from the rail using the tip of the razor.
- Gently raise the covering off the rail, and remove the excess from the stile.



Step 5: Doors

- Use a sanding block with 150 grit paper to sand in one direction (INWARD), to smooth the covering even with the face frame.
- Using a block of wood with a damp cloth, apply as much pressure as possible to the covering for good adhesion. Always go with the grain, not against it.

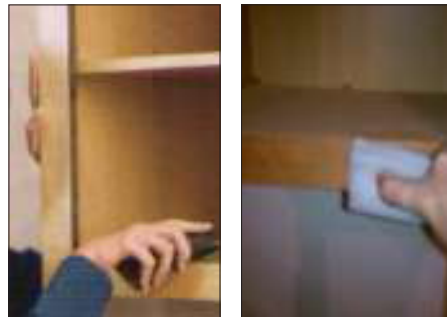

- Install hinges into bored recesses in the back of the door with the provided screws.
- Lightly mark with a pencil on the face frame the amount of your overlay (this was determined at order).
- Use a helper if possible to hold the door in place while you install screws through hinge plate into edge of frame. Hold the door so the edge is even with the pencil mark.



Step 4: Drawers (If Ordered)

- Install drawer glides in two parts; the part with the rollers are installed onto the bottom of the drawer. The “C” channels are installed inside the cabinet.
- Use supplied boots for framed cabinets. Frameless cabinets are usually installed without the boots.
- Attach a flat temporary board to the face of the drawer to aid in alignment. Be sure this board is flush with the face when the drawer is all the way in (see more detailed instructions in the following section).

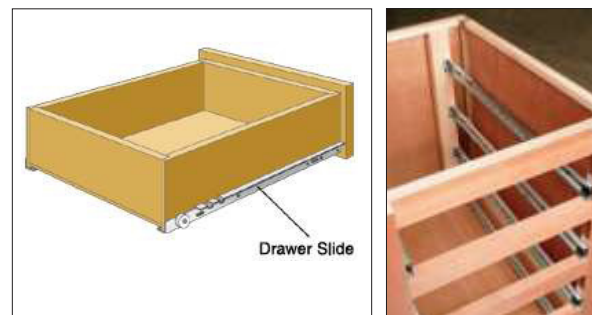

Step 6: Drawer Fronts

- Start with a drawer above a door, if possible. Determine the space between the door and drawer front, then cut a piece of scrap wood to this size to use as a spacer.
- Apply double stick tape to the back of the drawer front. Stick the drawer front onto the drawer.
- Open the door below, then pull out the drawer from underneath. Carefully remove drawer.
- Use pan head screws through the inside of the drawer into the back of the drawer front.



Installation Details

FABRICATING & INSTALLING DRAWER STRETCHERS

HORIZONTAL STRETCHERS are used to install drawer boxes in framed cabinets. They are made with 3/4” poplar or pine (or similar material) cut into 2 1/2” wide strips. The drawer slide boots will be attached to these stretchers. (For frameless cabinets, skip this section.)



Measure across the back of your cabinet from the left to right, and cut the stretcher to this dimension minus 1/16”. Do the same thing for all drawers. Put your stretcher inside the cabinets and bring them to the front of the cabinet facing, from behind the face frame. (Fig. A)

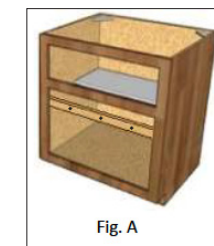

Make sure that it is even with the top of the drawer rail and mark the opening on the stretcher on each side at the frame. (Fig. B) Remove the stretcher and place it on a flat surface to mount the drawer boots. Your mounting boots need to be 1/8” away from the opening marks (see dotted lines on Fig. C) to compensate for the thickness of the boots.

Mount the boots flush with the bottom of the stretcher, using only one screw per boot until all adjustments are made and drawers roll smooth. Pre drill 2 to 3 holes using a 1/4” drill bit in the stretchers for installation to the walls. Follow the same steps for the rest of the drawers at this time before moving forward. (Fig. D)

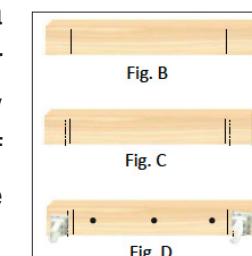

Measure from the floor of the base cabinet to the top of the drawer rail (Fig. E); mark this dimension on the cabinet back or wall. This is where the bottom of the boot is mounted using construction glue and 2” course screws (as long as there is enough depth in the back wall for the screw.)



Next set your cabinet side drawer tracks in place by sliding the back into the mounted boot. Make sure to push them in 1/8” past the front of the frame. Mark the screw holes and pre drill them with a 1/16” bit to avoid any frame splitting. Install the track with the 5/8” flat head screws that came in the package.

MOUNTING DRAWER BOX HARDWARE: Mount your drawer track sides using the vertical holes provided. It is not recommended to screw into the bottom of the plywood, as it will split even with pre drilling. Pre drill the holes and mount the track flush with the drawer box front. Use the 5/8” flat head screws that came in the packaging.

Slide your drawer in by putting the drawer box wheel over the cabinet track wheel and lifting up, then roll forward and let the drawer down.

Make adjustment to the tracks as necessary then install extra screws to the boots. The finished drawer should be flat with the cabinet framing left and right as well as flush with the top and bottom.

Installation Details Cont'd

INSTALLING DRAWERS IN FRAMELESS CABINETS

For frameless cabinets, you will not need the back stretchers, or the mounting boots. Simply attach the drawer slide tracks into the side walls of the cabinet interior.

DOOR HINGING AND HANGING



All doors will need to be hinged and hung in accordance to the overlays that were ordered. Doors will be pre drilled for the main hinge cup, but not the mounting holes. You will need to pre drill these holes or risk cracking your new doors. Mount your hinges, being careful not to over tighten and strip them out.

Doors will be pre drilled for the main hinge cup, but not the mounting holes. You will need to pre drill these holes or risk cracking your new doors. Mount your hinges, being careful not to over tighten and strip them out.

The hinges that you are using will automatically set the overlay on the hinge side. They have a tab that sticks out slightly that will stop the door at the front of the frame. The height can be determined as easily as measuring the overlay (such as 1/2") and marking it on the face with a soft pencil and setting the door in place. You will need to pre drill most of the cabinet stiles before mounting your doors as before to avoid cracking the cabinets. Hang the doors and make adjustments. There are 3 adjustments on the hinges; horizontal, vertical and camber. The most adjustment that you can expect is just short of 1/8".



DRAWER FRONTS

The simplest way to install drawer fronts is to first install the base doors, then line up drawer fronts over the door using a temporary spacer. Put double sided tape on the drawer box face, and press the front on firmly. This will only hold for a short while and you will need to secure with some 1" course drywall type screws. Be sure to pre drill and counter sink the holes from inside the drawer box to the front to ensure a tight front and a clean look on the interior of the drawer. Drawer fronts with recessed panels must be attached to drawer boxes with an "L" or "Angled" bracket to avoid penetrating panel face. Use only 1/2" screws to attach to both drawer front and drawer box.



Drill door and drawer front hardware by measuring from the center of the screw holes, transfer that dimension to the cabinet door face where you want them installed and drill the holes. Use a 3/16" sharp drill bit to bore the holes. There are many jigs on the market for door hanging and for drilling the handles. You can find tools like these at your local Home Depot®.

Cabinet Overlays

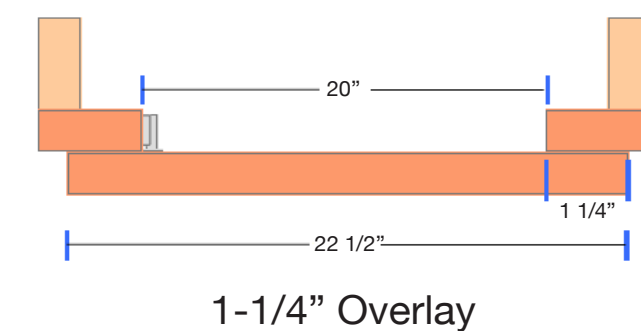
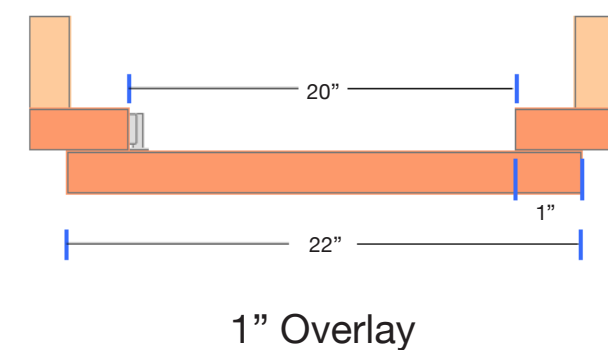
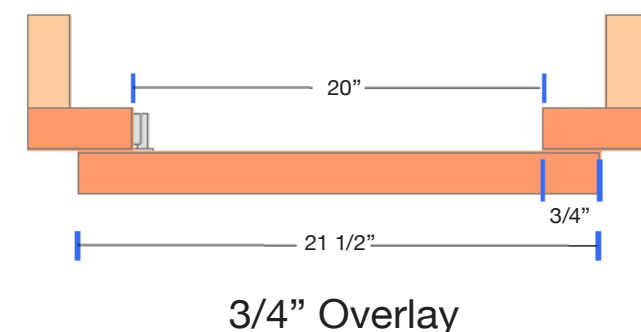
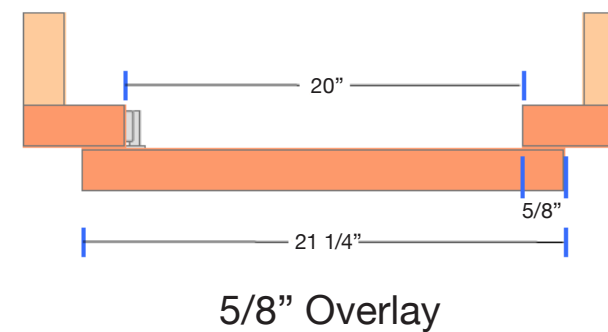
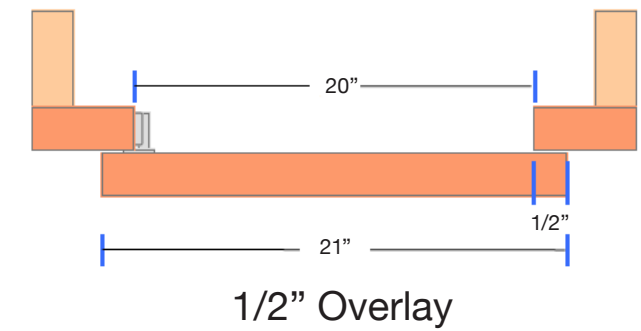
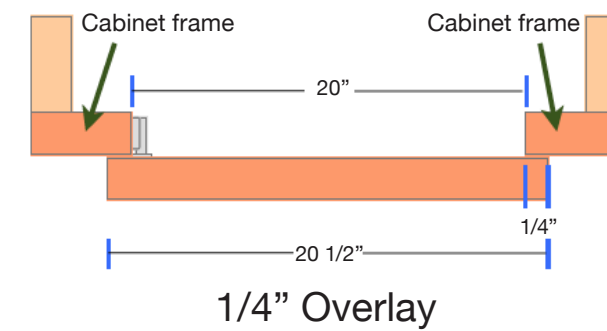

PREFER A PROFESSIONAL INSTALLER INSTEAD?

All of the information contained within is intended to help you complete your project to a level that you will be able to enjoy for years to come. Application of the tools and materials and the quality of the total overall job will greatly depend on your hand skills to complete these tasks. If you have any issue with 'Do-It-Yourself', we offer installed services. Please contact **1-800-HOMEDEPOT** for details.

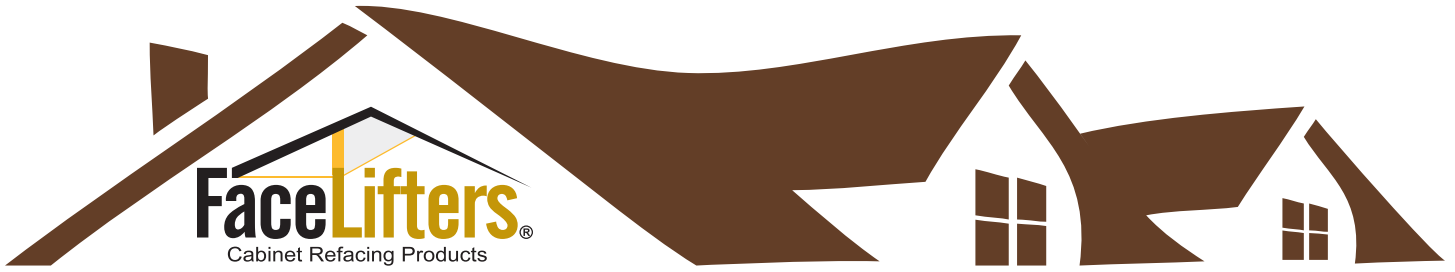

DO IT YOURSELF... CABINET REFACING

To view product options visit:

www.facelifters.com

Contact **1-800-HOMEDEPOT**
for details on Installed Services



More saving. More doing.®